

UMT MICPRO UHF-5100

UHF PLL MULTI CHANNELS WIRELESS MICROPHONE SYSTEM

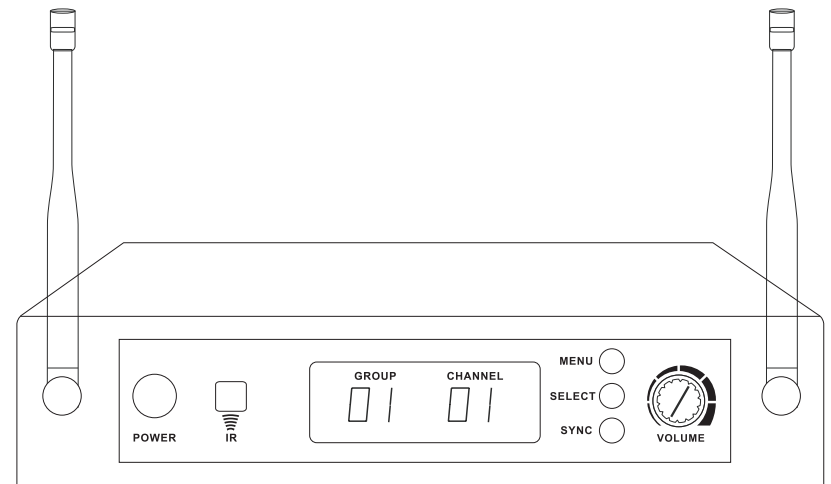

USER'S MANUAL

PLEASE READ THIS MANUAL CAREFULLY BEFORE OPERATION

INTRODUCTION

Thank you for choosing our UHF PLL multi channels wireless microphone system. Your new system is rugged, reliable, easy to set up and operate, and produces outstanding audio clarity. Whether you're a vocalist, guitarist or instrumentalist, this wireless system will show you how easy wireless can be, and how good wireless can sound. This user guide included with your system will tell you all you need to know to get your system working right away.

FEATURES

1. Microcomputer controlled PLL synthesized oscillation circuit.
2. UHF high band with multi selectable frequencies.
3. Automatic frequency selection and automatic transmitter setup.
4. Adopt high sensitivity and wide frequency response dynamic capsule to reproduce original sound.
5. Advanced compression circuit to avoid noise.
6. LCD display for easy operation.
7. Operating range is more than 100M in line and sight area.

PACKAGE CONTENTS

- | | |
|----------------------|-------|
| 1. Receiver | 1 PC |
| 2. AC/DC adapter | 1 PC |
| 3. 6.35mm cable | 1 PC |
| 4. 1/4 Wave Antennas | 2 PCS |
| 5. Transmitter | 1 PC |
| 6. AA batteries | 2 PCS |
| 7. User guide | 1 PC |

SPECIFICATIONS

RECEIVER

Frequency: fixed permitted
Frequency Stability: 10ppm
Sensitivity: 13dBuV
Adjacent channel rejection: 75dB
Image rejection: 95dB
Audio Output: 200MV
Output Impedance: XLR connector: 200 Ω ; 1 / 4 inch connector: 1k Ω
S/N ratio: 100dB
Total Harmonic Distortion: <0.1%
Frequency response: 50Hz-15KHz
Operating Range: 100m(in line and sight area)
Power supply: DC12V--18V
Housing: Metal

TRANSMITTER

Frequency: fixed permitted
Frequency Stability: 10ppm
Transmitting power: <10mW
Spurious emission: >65dB
Modulation: FM
Max modulation: 75K
Power supply: 3V (2 AA batteries)
Current consumption: 120mA

MANUAL SELECTION OF GROUP/CHANNEL

Any option displayed on screen will generally "time out" after five seconds.

MANUAL SELECTION OF RECEIVER GROUP/CHANNEL

Group Selection ① 2x ② ③

1. Press **MENU** twice. LCD screen will display **Group Select**.
2. Then press **SELECT** repeatedly to increase the group number.
3. When the correct group is displayed, either wait five seconds for the screen to time out, or press **SYNC** button to escape.

Channel Selection ① 3x ② ③

1. Press **MENU** three times. LCD screen will display **Channel Select**.
2. Then press **SELECT** repeatedly to increase the channel number.
3. When the correct channel is displayed, either wait five seconds for the screen to time out, or press **SYNC** button to escape.

We suggest to use Auto Channel Select to select the best channels.

MANUAL SELECTION OF TRANSMITTER GROUP/CHANNEL

1. Press and hold the **SELECT** button until the GROUP and CHANNEL displays begin to alternate.
2. To change the group setting, release the **SELECT** button while GROUP is displayed. While GROUP is flashing, pressing **SELECT** button repeatedly to increase the group setting.
3. To change the channel setting, release the **SELECT** button while CHANNEL is displayed. While CHANNEL is flashing, pressing **SELECT** button to increase the channel setting.

RECEIVER PARTS DESCRIPTION

Front

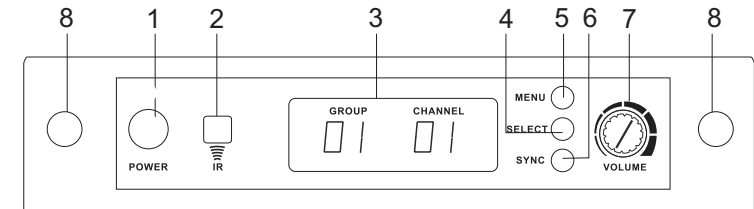

Rear

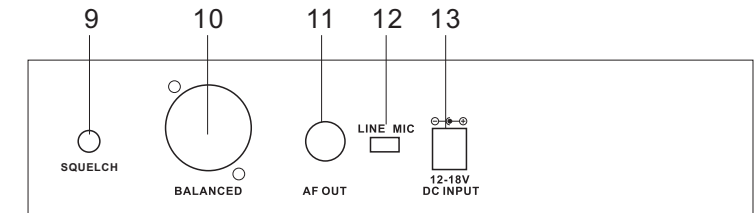

1. On/Off switch: Turn on/off the receiver.
2. Infrared (IR) port: Broadcasts IR signal to transmitter to synchronize frequencies.
3. LCD display: display group, channel no, RF and AF level.
4. Select switch: Press to select the currently displayed menu option.
5. Menu switch: Press to scroll through menu options.
6. Sync Button: Press to initiate IR connection between receiver and transmitter.
7. Volume control: Turn to adjust volume.
8. Antenna connector: To install supplied antenna here.
9. Squelch adjust
10. Individual Balanced XLR output
11. Mixed 1 / 4 " output jack
12. MIC/LINE switch
13. DC input jack

HANDHELD MICROPHONE PARTS DESCRIPTION

1. Interchangeable microphone head
2. Power / Infrared(IR) /Mute indicator: Green-ready; Orange-mute on; Flashing orange-IR transmission in process
3. LCD screen: display group, channel number and battery power.
4. On-off / mute switch: Press and hold 1~2 seconds to turn microphone on or off. Press shortly to mute/unmute.
5. Select switch: To set up transmitter channel manually.
6. Battery cover/compartment
7. IR port: Receives infrared beam from receiver to synchronize frequencies.

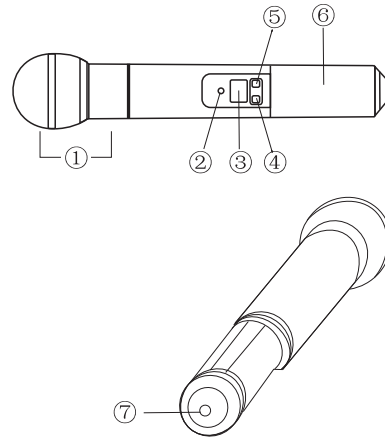

SYSTEM SETUP

Note: Transmitting devices such as cellular phones and two-way radios may interfere with wireless audio transmissions. Keep your transmitters and receivers away from these and other potential sources of interference.

SINGLE SYSTEM SETUP

Receiver Automatic Frequency Selection ① ②

1. Turn on the receiver.
2. Press **MENU** once and then **SELECT**. Receiver will start searching for a clear channel automatically.

Automatic Transmitter Setup

1. After receiver channel is set, turn on the transmitter.
2. Open the transmitter battery compartment to expose the IR port.
3. With the IR port pointed to the receiver, press **SYNC** on receiver.
4. Transmitter power indicator will flash orange. When the indicator stops flashing and light green, and receiver RF indicator will light green, the transmitter is SYNC to the receiver.
5. Close the transmitter battery compartment.

MULTIPLE SYSTEM SETUP

When using multiple systems in a single installation, repeat above steps to set up each system.

- ▶ **Be sure that only one transmitter IR port is exposed when synchronizing a system.**
- ▶ **When you set 2nd system receiver channel please keep 1st system transmitter on.**

BODY PACK TRANSMITTER PARTS DESCRIPTION

1. Antenna
2. LCD screen: display channel number and battery power.
3. Select switch: to set up transmitter channel manually.
4. IR port: Receives infrared beam from receiver to synchronize frequencies.
5. Battery cover/compartment
6. Power / IR / Mute indicator: Green-ready; Orange-mute on; Flashing orange-IR transmission in process
7. On-off / mute switch: Press and hold 1~2 seconds to turn on/off transmitter. Press shortly to mute/unmute.
8. 3-Pin Microphone Input Jack
9. Belt clip

